

**NOTES:**

1. INSIDE DOOR HANDLES ARE OPTIONAL ON SINGLE POINT, MULT-LATCH DOORS

2. INSIDE DOOR HANDLES ARE NOT AVAILABLE ON FF, AF, RF, HF & DI SEGMENTS.

3. ITEM 9 (Z SAFETY CATCH) IS REQUIRED ON ALL POSITIVE PRESSURE DOORS. MOUNT ITEM 9 ON TOP LATCH ON 2 LATCH DOORS AND ON CENTER LATCH ON 3 LATCH DOORS. REFER TO DRAWING #386-02030-003 FOR ASSEMBLY DETAILS.

4. ITEM 10 (ROD BRACKET) IS REQUIRED ON ALL RODS SPANNING OVER 36". MOUNT ITEM 10 ON DOOR LINER CENTERED IN ROD SPAN USING TWO (2) SCREWS #021-30530-042. REQUIRED ON DOORS 50.88"H THRU 68.88"H (1 REQ'D) AND DOORS 86.88"H THRU 128.88"H (2 REQ'D).

**\*\* QTY OF DOOR LATCHES**

QTY	DOOR HEIGHT
2	20.88" - 68.88"
3	71.88" - 128.88"

	ITEM	QTY	PART NO.	DESCRIPTION
STANDARD	1	1	034-12001-001	NL L-HANDLE W/SCREW&PLASTIC CAP
OPTIONAL	1	1	034-12001-007	KL L-HANDLE W/SCREW&PLASTIC CAP
OPTIONAL	1	1	034-12001-011	PL L-HANDLE W/SCREW&PLASTIC CAP
	2	**1	034-12002-001	MECHANISM, LATCHING w/JAM&LOCK NUT
	3	**1	034-12002-011	CAM, ROLLER SNUB NOSE
OPTIONAL	4	1	034-12001-005	INSIDE HANDLE W/PLASTIC GRIP
	5	1 OR 2	034-12002-007	COVER PLUG FOR LOCK
	6	**1	034-12002-010	ADAPTER, LINKAGE
	7	1	086-02023-XXX	ROD, 0.315" DIA XX LONG ZINC PLATED
	8	**3	021-01267-000	FLAT WASHER
OPTIONAL-SEE NOTE 3	9	1	086-28204-001	CATCH Z SAFETY, OUTSWING DOOR
SEE NOTE 4	10	1	086-25104-004	BRACKET, ROD

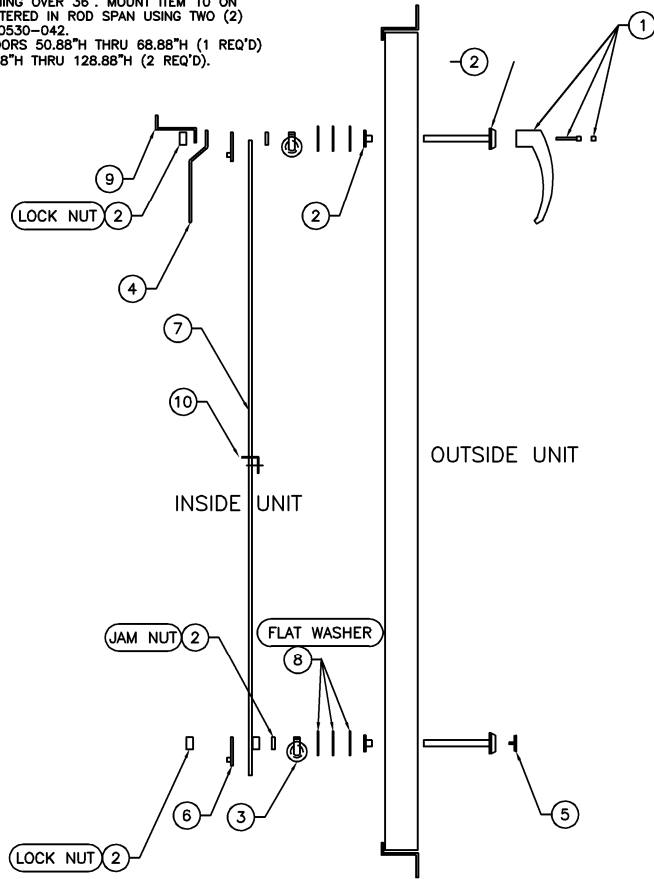

STANDARD DOOR  
MULTI-POINT OUT SWING  
2 LATCHES

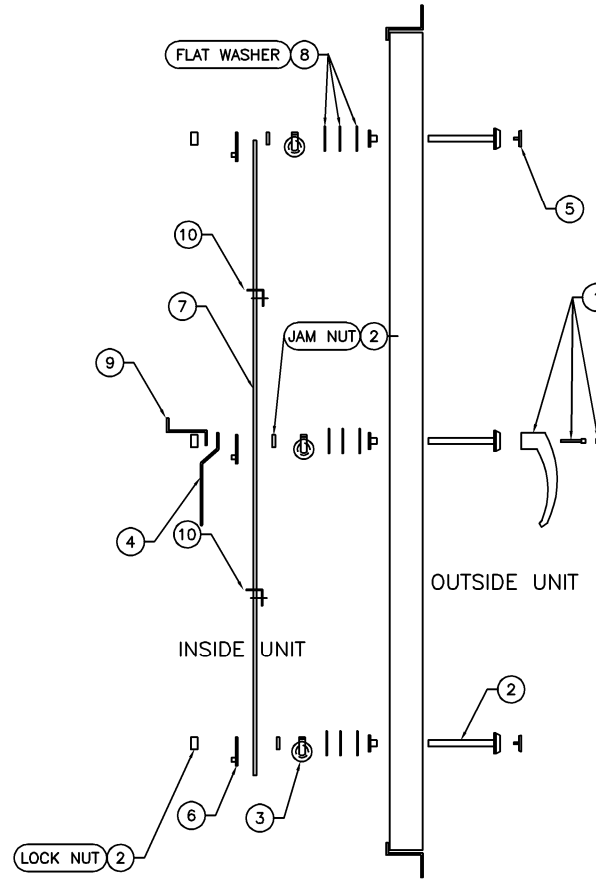

STANDARD DOOR  
MULTI-POINT OUT SWING  
3 LATCHES

\*\*NOTE: MULTIPLY QUANTITIES OF EACH ITEM ABOVE BY QUANTITY OF DOOR LATCHES TO GET PROPER QUANTITIES FOR THE VARIOUS DOOR HEIGHTS.

ROD LENGTH FOR DOOR HEIGHTS		
DASH #	LENGTH	DOOR HEIGHT
001	10"	20.88"
002	13"	23.88"
003	16"	26.88"
004	19"	29.88"
005	22"	32.88"
006	25"	35.88"
007	28"	38.88"
008	31"	41.88"
009	34"	44.88"
010	37"	47.88"
011	40"	50.88"
012	43"	53.88"
013	46"	56.88"
014	49"	59.88"
015	52"	62.88"
016	55"	65.88"
017	58"	68.88"
018	61"	71.88"
019	64"	74.88"
020	67"	77.88"
021	70"	80.88"
022	73"	83.88"
023	76"	86.88"
024	79"	89.88"
025	82"	92.88"
026	85"	95.88"
027	88"	97.88"
028	91"	101.88"
029	94"	104.88"
030	97"	107.88"
031	100"	110.88"
032	103"	113.88"
033	106"	116.88"
034	109"	119.88"
035	112"	122.88"
036	115"	125.88"
037	118"	128.88"



Building Efficiency

REV LEV	DATE	REVISION RECORD	DR.	CHG. NO.
-	1/15/10	NEW	SVS	09-2246

DIMENSIONS ARE IN INCHES  
TOLERANCES:  
PER ENG.  
SPEC.  
MORSE  
WELDING:  
PER ENG.  
SPEC.  
M-M-D

Multi-Pt Latching Parts  
Out Swing Door

MATERIAL TYPE: STL GALV ENG. STD. R259  
CUT SIZE:

SIZE DRAWING NUMBER  
A 386-02205-003

SCALE: NTS SHEET: 1 OF 1

ALL PROPRIETARY RIGHTS IN THE SUBJECT MATTER HEREOF ARE RESERVED AND NO PERMISSION IS GRANTED TO REPRODUCE THIS PRINT IN WHOLE OR IN PART OR TO DISCLOSE ANY OF THE INFORMATION UPON IT TO OTHERS WITHOUT WRITTEN RELEASE BY JOHNSON CONTROLS INC.